



TÊ HÀN THÉP

MÃ SẢN PHẨM
TÊN SẢN PHẨM

SP - 32
TÊ HÀN THÉP ĐÚC ASTM A234 WPB ANSI
B16.9

Kiểu Nối

Hàn đối đầu - Butt-welding - (B/W)

Chất Liệu

Thép đúc - Carbon Steel ASTM A234 GR WBP

Tiêu Chuẩn	ASME/ANSI B 16.9 ~ B 16.25 ~ B 16.28
Độ Dày	STD ~ SCH 40s ~ SCH 80s ~ SCH 120s ~ SCH160s ~ XXs
Kích Cỡ	DN 15A → DN 1200A ⇔ (21.3 mm → 1219.2 mm)
Sử Dụng	Nước, gas, xăng, dầu, thủy lực, hơi nóng, khí nén,...
Tình Trạng	Hàng có sẵn, mới 100%
Xuất Xứ	Trung Quốc - Đài Loan
Đơn Giá	Xin liên hệ

Equal and reducing tees

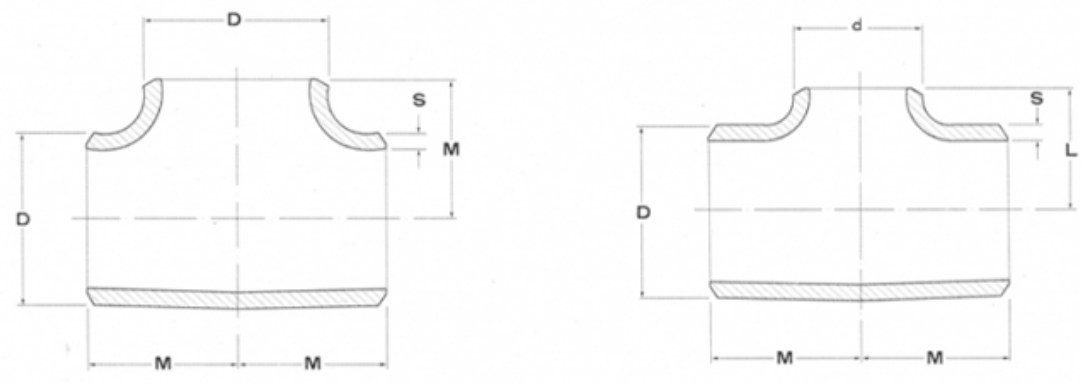

D	d	M	L	Ødia.	SCH.STD		SCH.XS		SCH.10		SCH.20		SCH.30		SCH.40		
					S	S1	S	S1	S	S1	S	S1	S	S1	S	S1	
21.3	-	25.4	25.4	1/2"	2.77	-	3.73	-	-	-	-	-	-	-	2.77	-	
26.7	-	28.5	28.5	3/4"	2.87	-	3.91	-	-	-	-	-	-	-	2.87	-	
26.7	21.3			3/4"x 1/2"	2.87	2.77	3.91	3.73	-	-	-	-	-	-	-	2.87	2.77
33.4	-	38.1	38.1	1"	3.38	-	4.55	-	-	-	-	-	-	-	3.38	-	
33.4	26.7			1"x 3/4"	3.38	2.87	4.55	3.91	-	-	-	-	-	-	-	3.38	2.87
33.4	21.3			1"x 1/2"	3.38	2.77	4.55	3.73	-	-	-	-	-	-	-	3.38	2.77
42.2	-	47.6	47.6	1-1/4"	3.56	-	4.85	-	-	-	-	-	-	-	3.56	-	
42.2	33.4			1-1/4"x 1"	3.56	3.38	4.85	4.55	-	-	-	-	-	-	-	3.56	3.38
42.2	26.7			1-1/4"x 3/4"	3.56	2.87	4.85	3.91	-	-	-	-	-	-	-	3.56	2.87
42.2	21.3			1-1/4"x 1/2"	3.56	2.77	4.85	3.73	-	-	-	-	-	-	-	3.56	2.77
48.3	-			57.1	57.1	1-1/2"	3.68	-	5.08	-	-	-	-	-	-	-	3.68
48.3	42.2	1-1/2"x 1-1/4"	3.68			3.56	5.08	4.85	-	-	-	-	-	-	-	3.68	3.56
48.3	33.4	1-1/2"x 1"	3.68			3.38	5.08	4.55	-	-	-	-	-	-	-	3.68	3.38
48.3	26.7	1-1/2"x 3/4"	3.68			2.87	5.08	3.91	-	-	-	-	-	-	-	3.68	2.87
48.3	21.3	1-1/2"x 1/2"	3.68			2.77	5.08	3.73	-	-	-	-	-	-	-	3.68	2.77
60.3	-	63.5	63.5	2"	3.91	-	5.54	-	-	-	-	-	-	-	3.91	-	
60.3	48.3			2"x 1-1/2"	3.91	3.68	5.54	5.08	-	-	-	-	-	-	-	3.91	3.68
60.3	42.4			2"x 1-1/4"	3.91	3.56	5.54	4.85	-	-	-	-	-	-	-	3.91	3.56
60.3	33.4			2"x 1"	3.91	3.38	5.54	4.55	-	-	-	-	-	-	-	3.91	3.38
60.3	26.7			2"x 3/4"	3.91	2.87	5.54	3.91	-	-	-	-	-	-	-	3.91	2.87
60.3	21.3			2"x 1/2"	3.91	2.77	5.54	3.73	-	-	-	-	-	-	-	3.91	2.77
73.0	-	76.2	76.2	2-1/2"	5.16	-	7.01	-	-	-	-	-	-	-	5.16	-	
73.0	60.3			2-1/2"x 2"	5.16	3.91	7.01	5.54	-	-	-	-	-	-	-	5.16	3.91
73.0	48.3			2-1/2"x 1-1/2"	5.16	3.68	7.01	5.08	-	-	-	-	-	-	-	5.16	3.68
73.0	42.2			2-1/2"x 1-1/4"	5.16	3.56	7.01	4.85	-	-	-	-	-	-	-	5.16	3.56
73.0	33.4			2-1/2"x 1"	5.16	3.38	7.01	4.55	-	-	-	-	-	-	-	5.16	3.38
88.9	-	85.7	85.7	3"	5.49	-	7.62	-	-	-	-	-	-	-	5.49	-	
88.9	73.0			3"x 2-1/2"	5.49	5.16	7.62	7.01	-	-	-	-	-	-	-	5.49	5.16
88.9	60.3			3"x 2"	5.49	3.91	7.62	5.54	-	-	-	-	-	-	-	5.49	3.91
88.9	48.3			3"x 1-1/2"	5.49	3.68	7.62	5.08	-	-	-	-	-	-	-	5.49	3.68
88.9	42.2			3"x 1-1/4"	5.49	3.56	7.62	4.85	-	-	-	-	-	-	-	5.49	3.56
88.9	33.4			3"x 1"	5.49	3.38	7.62	4.55	-	-	-	-	-	-	-	5.49	3.38
101.6	-	95.2	95.2	3-1/2"	5.74	-	8.08	-	-	-	-	-	-	-	5.74	-	
101.6	88.9			3-1/2"x 3"	5.74	5.49	8.08	7.62	-	-	-	-	-	-	-	5.74	5.49
101.6	73.0			3-1/2"x 2-1/2"	5.74	5.16	8.08	7.01	-	-	-	-	-	-	-	5.74	5.16

stainless & carbon steel

Equal and Reducing Tees

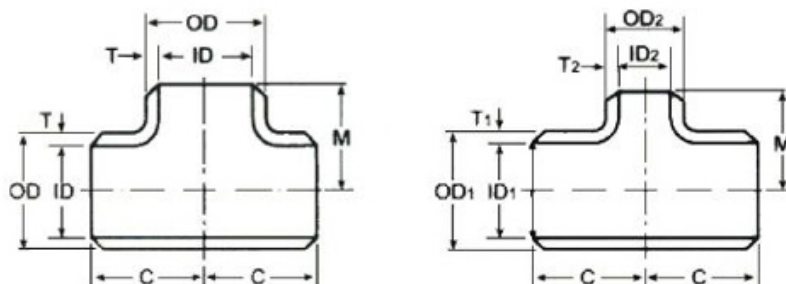

MSS SP-75 ANSI B16.9 (in mm)
* Wellgrow's standard.

Nominal Pipe Size (NPS)	Outside Diameter At Bevel D		Center to End		Nominal Pipe Size (NPS)	Outside Diameter At Bevel D		Center to End	
	Run	Outlet	Run C	Outlet (1) M		Run	Outlet	Run C	Outlet (1) M
14 x 14	355.6	355.6	279.4	279.4	26 x 22		558.8		469.9
14 x 12		323.9		269.7	26 x 20		508.0		457.2
14 x 10		273.1		257.0	26 x 18		457.2		444.5
14 x 8		219.1		247.6	26 x 16		406.4		431.8
14 x 6		168.3		238.3	26 x 14		355.6		431.8
16 x 16	406.4	406.4	304.8	304.8	26 x 12		323.1		422.1
16 x 14		355.6		304.8	28 x 28	711.2	711.2	520.7	520.7
16 x 12		323.9		295.1	28 x 26		660.4		520.7
16 x 10		273.1		282.4	28 x 24		609.6		508.0
16 x 8		219.1		373.0	28 x 22		558.8		495.3
16 x 6		168.3		263.7	28 x 20		508.0		482.6
18 x 18	457.2	457.2	342.9	342.9	28 x 18		457.2		469.9
18 x 16		406.4		330.2	28 x 16		406.4		457.2
18 x 14		355.6		330.2	28 x 14		355.6		457.2
18 x 12		323.9		320.5	28 x 12		323.1		447.5
18 x 10		273.1		307.8	30 x 30	762.0	762.0	558.8	558.8
18 x 8		219.1		298.4	30 x 28		711.2		546.1
20 x 20	508.0	508.0	381.0	381.0	30 x 26		660.4		546.1
20 x 18		457.2		369.3	30 x 24		609.6		533.4
20 x 16		406.4		355.6	30 x 22		558.8		520.7
20 x 14		355.6		355.6	30 x 20		508.0		508.0
20 x 12		323.9		345.9	30 x 18		457.2		495.3
20 x 10		273.1		333.2	30 x 16		406.4		482.6
20 x 8		219.1		323.8	30 x 14		355.6		482.6
22 x 22	558.8	558.8	419.1	419.1	30 x 12		323.9		472.6
22 x 20		508.0		406.4	30 x 10		273.1		460.2
22 x 18		457.2		393.7	32 x 32	812.8	812.8	596.9	596.9
22 x 16		406.4		381.0	32 x 30		762.0		584.2
22 x 14		355.6		381.0	32 x 28		711.2		571.5
22 x 12		323.9		371.3	32 x 26		660.4		571.5
22 x 10		273.1		358.6	32 x 24		609.6		558.8
24 x 24	609.6	609.6	431.8	431.8	32 x 22		558.8		546.1
24 x 22		558.8		431.8	32 x 20		508.0		533.4
24 x 20		508.0		431.8	32 x 18		457.2		520.7
24 x 18		457.2		419.1	32 x 16		406.4		508.0
24 x 16		406.4		406.4	32 x 14		355.6		508.0
24 x 14		355.6		406.4	34 x 34	863.6	863.6	635.0	635.0
24 x 12		323.9		396.7	34 x 32		812.8		622.3
24 x 10		273.1		384.0	34 x 30		762.0		609.6
26 x 26	660.4	660.4	495.3	495.3	34 x 28		711.2		596.9
26 x 24		609.6		482.6	34 x 26		660.4		596.9

(1) Outlet dimension "M" for run sizes 14 and larger is recommended but not mandatory.

Equal and reducing tees

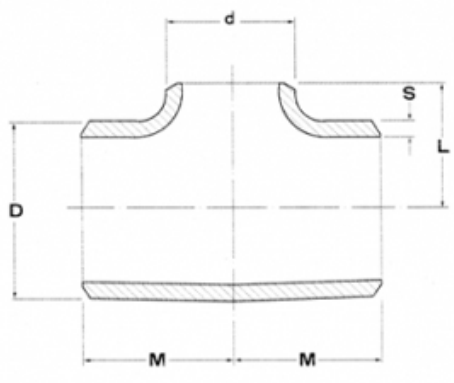
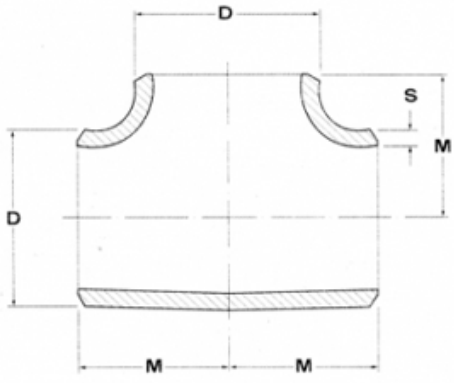

D	d	M	L	Ødia.	SCH.STD		SCH.XS		SCH.10		SCH.20		SCH.30		SCH.40		
					S	S1	S	S1	S	S1	S	S1	S	S1	S	S1	
101.6	60.3	95.2	82.6	3-1/2" x 2"	5.74	3.91	8.08	5.54	-	-	-	-	-	-	5.74	3.91	
101.6	48.3		79.4	3-1/2" x 1-1/2"	5.74	3.68	8.08	5.08	-	-	-	-	-	-	5.74	3.68	
101.6	42.2		77.4	3-1/2" x 1-1/4"	5.74	3.56	8.08	4.85	-	-	-	-	-	-	5.74	3.56	
114.3	-	104.8	104.8	4"	6.02	-	8.56	-	-	-	-	-	-	-	6.02	-	
114.3	101.6		101.6	4" x 3-1/2"	6.02	5.74	8.56	8.08	-	-	-	-	-	-	6.02	5.74	
114.3	88.9		98.4	4" x 3"	6.02	5.49	8.56	7.62	-	-	-	-	-	-	6.02	5.49	
114.3	73.0		95.2	4" x 2-1/2"	6.02	5.16	8.56	7.01	-	-	-	-	-	-	6.02	5.16	
114.3	60.3		88.9	4" x 2"	6.02	3.91	8.56	5.54	-	-	-	-	-	-	6.02	3.91	
114.3	48.3		85.7	4" x 1-1/2"	6.02	3.68	8.56	5.08	-	-	-	-	-	-	6.02	3.68	
114.3	42.2		83.7	4" x 1-1/4"	6.02	3.56	8.56	4.85	-	-	-	-	-	-	6.02	3.56	
114.3	33.4		78.6	4" x 1"	6.02	3.38	8.56	4.55	-	-	-	-	-	-	6.02	3.38	
141.3	-		123.8	123.8	5"	6.55	-	9.52	-	-	-	-	-	-	-	6.55	-
141.3	114.3			117.4	5" x 4"	6.55	6.02	9.52	8.56	-	-	-	-	-	-	6.55	6.02
141.3	101.6	114.3		5" x 3-1/2"	6.55	5.74	9.52	8.08	-	-	-	-	-	-	6.55	5.74	
141.3	88.9	111.1		5" x 3"	6.55	5.49	9.52	7.62	-	-	-	-	-	-	6.55	5.49	
141.3	73.0	107.9		5" x 2-1/2"	6.55	5.16	9.52	7.01	-	-	-	-	-	-	6.55	5.16	
141.3	60.3	104.7		5" x 2"	6.55	3.91	9.52	5.54	-	-	-	-	-	-	6.55	3.91	
168.3	-	142.8	142.8	6"	7.11	-	10.97	-	-	-	-	-	-	-	7.11	-	
168.3	141.3		136.5	6" x 5"	7.11	6.55	10.97	9.52	-	-	-	-	-	-	7.11	6.55	
168.3	114.3		130.1	6" x 4"	7.11	6.02	10.97	8.56	-	-	-	-	-	-	7.11	6.02	
168.3	101.6		127.0	6" x 3-1/2"	7.11	5.74	10.97	8.08	-	-	-	-	-	-	7.11	5.74	
168.3	88.9		123.8	6" x 3"	7.11	5.49	10.97	7.62	-	-	-	-	-	-	7.11	5.49	
168.3	73.0		120.6	6" x 2-1/2"	7.11	5.16	10.97	7.01	-	-	-	-	-	-	7.11	5.16	
168.3	60.3		115.9	6" x 2"	7.11	3.91	10.97	5.54	-	-	-	-	-	-	7.11	3.91	
219.1	-		177.8	177.8	8"	8.18	-	12.70	-	-	-	6.35	-	7.04	-	8.18	-
219.1	168.3	168.2		8" x 6"	8.18	7.11	12.70	10.97	-	-	-	-	-	-	8.18	7.11	
219.1	141.3	161.9		8" x 5"	8.18	6.55	12.70	9.52	-	-	-	-	-	-	8.18	6.55	
219.1	114.3	155.5		8" x 4"	8.18	6.02	12.70	8.56	-	-	-	-	-	-	8.18	6.02	
219.1	101.6	152.4		8" x 3-1/2"	8.18	5.74	12.70	8.08	-	-	-	-	-	-	8.18	5.74	
219.1	88.9	150.8		8" x 3"	8.18	5.49	12.70	7.62	-	-	-	-	-	-	8.18	5.49	
273.0	-	215.9		215.9	10"	9.27	-	12.70	-	-	-	6.35	-	7.80	-	9.27	-
273.0	219.1		203.2	10" x 8"	9.27	8.18	12.70	12.70	-	-	6.35	6.35	7.80	7.04	9.27	8.18	
273.0	168.3		193.7	10" x 6"	9.27	7.11	12.70	10.97	-	-	-	-	-	-	9.27	7.11	
273.0	141.3		190.5	10" x 5"	9.27	6.55	12.70	9.52	-	-	-	-	-	-	9.27	6.55	
273.0	114.3		184.2	10" x 4"	9.27	6.02	12.70	8.56	-	-	-	-	-	-	9.27	6.02	

weights of the fittings



Type	DIAM.	1/2"	3/4"	1"	1-1/4"	1-1/2"	2"	2-1/2"	3"	3-1/2"	4"	5"	6"	8"
	SCH mm	21.3	26.7	33.4	42.2	48.3	60.3	73.0	88.9	101.6	114.3	141.3	168.3	219.1
	STD		0.09	0.10	0.20	0.30	0.40	0.80	1.00	1.40	1.60	2.80	4.00	6.50
	XS		0.16	0.20	0.30	0.40	0.60	1.00	1.40	2.00	2.20	4.00	6.00	9.90
	10	-	-	-	-	-	-	-	-	-	-	-	-	-
	20	-	-	-	-	-	-	-	-	-	-	-	-	5.80
	30	-	-	-	-	-	-	-	-	-	-	-	-	6.20
	40		0.09	0.10	0.20	0.30	0.40	0.80	1.00	1.40	1.60	2.80	4.00	6.50
	60	-	-	-	-	-	-	-	-	-	-	-	-	8.60
	80		0.16	0.20	0.30	0.40	0.60	1.00	1.40	2.00	2.20	4.00	6.00	9.90
	100	-	-	-	-	-	-	-	-	-	-	-	-	12.60
	120	-	-	-	-	-	-	-	-	-	3.00	5.60	8.30	15
	140	-	-	-	-	-	-	-	-	-	-	-	-	17
	160			0.25	0.30	0.50	1.10	1.60	2.00	2.80	4.00	7.00	10.50	18
	XXS			0.35	0.45	0.70	1.30	2.10	2.60	3.70	4.70	8.00	12.30	18
	STD	0.10	0.16	0.36	0.50	0.70	1.00	1.80	2.70	3.55	4.40	7.00	10	19
	XS	0.16	0.22	0.47	0.70	0.90	1.40	2.20	3.00	4.89	6.40	9.30	15	28.90
	10	-	-	-	-	-	-	-	-	-	-	-	-	-
	20	-	-	-	-	-	-	-	-	-	-	-	-	-
	30	-	-	-	-	-	-	-	-	-	-	-	-	-
	40	0.10	0.16	0.36	0.50	0.70	1.00	1.80	2.70	3.55	4.40	7.00	10	19
	60	-	-	-	-	-	-	-	-	-	-	-	-	-
	80	0.16	0.22	0.47	0.70	0.90	1.40	2.20	3.00	4.89	6.40	9.30	15	28.90
	100	-	-	-	-	-	-	-	-	-	-	-	-	
	120	-	-	-	-	-	-	-	-	-	-	-	-	
	140	-	-	-	-	-	-	-	-	-	-	-	-	
	160	0.25	0.35	0.80	1.00	1.50	2.50	4.00	6.00	8.00	10	20	25	52
	XXS	0.30	0.45	1.00	1.20	1.80	3.00	6.00	8.00	11	13	24	30	52
	STD	0.13	0.20	0.47	0.65	0.91	1.30	2.35	3.50	4.60	5.70	9.10	13	24.70
	XS	0.20	0.30	0.61	0.91	1.17	1.85	2.90	3.90	6.35	8.30	12	19.50	37.60
	10	-	-	-	-	-	-	-	-	-	-	-	-	-
	20	-	-	-	-	-	-	-	-	-	-	-	-	-
	30	-	-	-	-	-	-	-	-	-	-	-	-	
	40	0.13	0.20	0.47	0.65	0.91	1.30	2.35	3.50	4.60	5.70	9.10	13	24.70
	60	-	-	-	-	-	-	-	-	-	-	-	-	
	80	0.20	0.30	0.61	0.91	1.17	1.85	2.90	3.90	6.35	8.30	12	19.50	37.60
	100	-	-	-	-	-	-	-	-	-	-	-	-	
	120	-	-	-	-	-	-	-	-	-	-	-	-	
	140	-	-	-	-	-	-	-	-	-	-	-	-	
	160	0.32	0.45	1.04	1.30	1.95	3.25	5.20	7.80	10.40	13	26	32.5	67.60
	XXS	0.40	0.60	1.30	1.56	2.35	3.90	7.80	10.40	14.30	16.90	31.20	39	37.60
		STD	0.03	0.06	0.10	0.20	0.25	0.30	0.40	0.60	1.10	1.20	2.10	3.60
XS		0.05	0.10	0.15	0.25	0.30	0.35	0.50	0.90	1.70	2.00	3.00	5.00	7.00
10		-	-	-	-	-	-	-	-	-	-	-	-	
20		-	-	-	-	-	-	-	-	-	-	-	-	
30		-	-	-	-	-	-	-	-	-	-	-	-	
40		0.03	0.06	0.10	0.20	0.25	0.30	0.40	0.60	1.10	1.20	2.10	3.60	5.50
60		-	-	-	-	-	-	-	-	-	-	-	-	
80		0.05	0.10	0.15	0.25	0.30	0.35	0.50	0.90	1.70	2.00	3.00	5.00	7.00
100		-	-	-	-	-	-	-	-	-	-	-	-	
120		-	-	-	-	-	-	-	-	-	-	-	-	
	140	-	-	-	-	-	-	-	-	-	-	-	-	
	160	0.10	0.10	0.15	0.25	0.30	0.55	0.90	1.40	2.50	3.00	5.50	7.50	18
	XXS	0.15	0.15	0.20	0.30	0.40	0.60	1.00	1.80	2.70	4.00	7.00	9.00	18

Sản phẩm khác



—

[RẮC CO REN THÉP RÈN A105](#)

[Xem thêm RẮC CO REN THÉP RÈN A105](#)



—

CÀ RÁ REN ÁP LỰC INOX 304L

Xem thêm [CÀ RÁ REN ÁP LỰC INOX 304L](#)



—

MẶT BÍCH RỔNG INOX 304

Xem thêm [MẶT BÍCH RỔNG INOX 304](#)



—

MẶT BÍCH INOX 304

[Xem thêm MẶT BÍCH INOX 304](#)



—

[MẶT BÍCH MÙ THÉP SS400 DIN 2527 PN40](#)

[Xem thêm MẶT BÍCH MÙ THÉP SS400 DIN 2527 PN40](#)



—

[MẶT BÍCH CỔ INOX 304 ANSI CLASS 150 LBS](#)

[Xem thêm MẶT BÍCH CỔ INOX 304 ANSI CLASS 150 LBS](#)

